



Memoirs®

5.5' VibrAcoustic® Bath

K-1170-VB



Features

- Center drain.
- VibrAcoustic® technology emits sound waves and offers a surround sound experience.
- Six transducers and a control amplifier with 25' (7.6 m) of wiring.
- High-resolution color screen in polished chrome.
- Integral lumbar support.
- Coordinates with other products in the Memoirs collection.
- 66" (1676 mm) x 42" (1067 mm) x 22" (559 mm)

Material

- Acrylic

Installation

- Drop-in

Recommended Accessories

1184460 Kit, UI Mounting
K- 1491 Bath/Whirlpool Pillow
K- 1601 Bath/Whirlpool Footstop
K- 7161-AF Bath Drain
K- 7213 27" Cable Bath Drain
K- 7214 27" Cable Bath Drain
K- 7265 Clearflo Bath Drain



Codes/Standards





CSA B45.5/IAPMO Z124
ASTM E162
ASTM E662
UL 1795
CSA C22.2 No. 218.2
Greenguard UL 2818 - Gold
CARB P2

KOHLER® One-Year Limited Warranty

See website for detailed warranty information.

Available Color/Finishes

Color tiles intended for reference only.

Color	Code	Description
	0	White
	96	Biscuit
	47	Almond
	NY	Dune
	G9	Sandbar

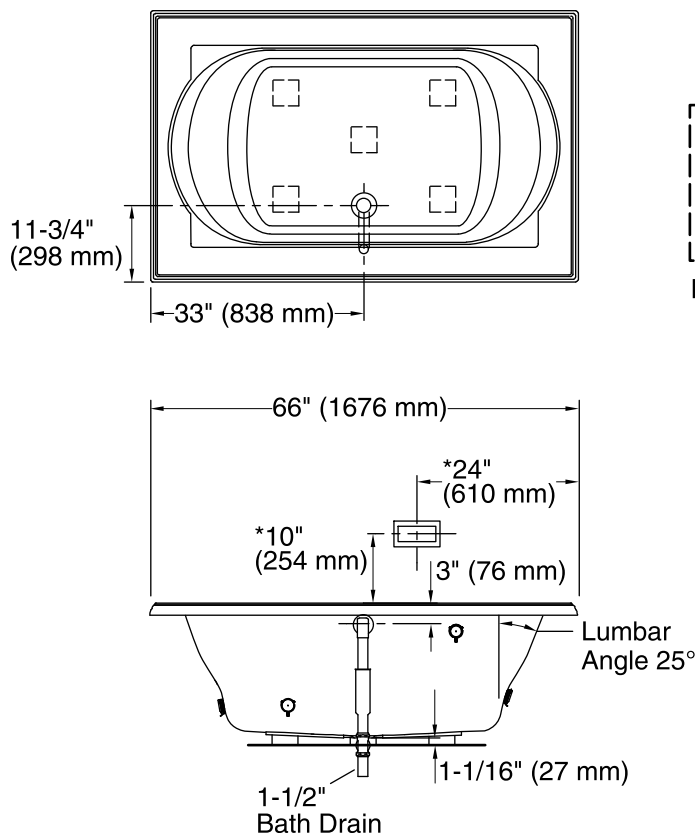

No change in measurements if connected with drain illustrated. (K-7161-AF)

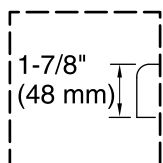

Drop-in Rim Detail

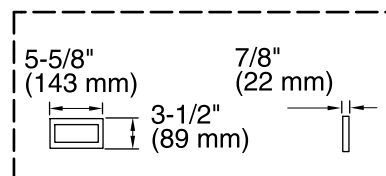

User Interface

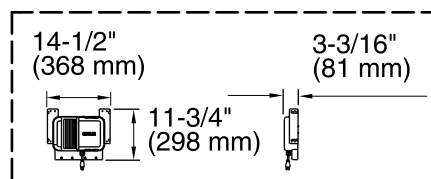

Control Amplifier

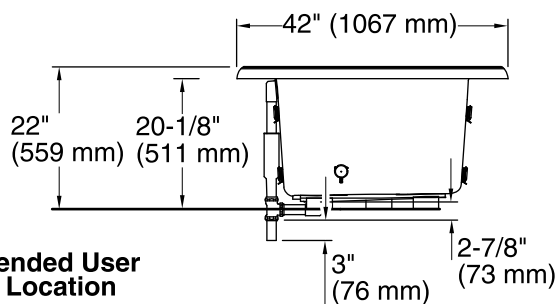

***Recommended User Interface Location**

Required Electrical Service

One circuit required, protected with Class A Ground-Fault Circuit-Interrupter (GFCI) or Residual Current Device (RCD).

Amplifier: 120 V, 15 A, 50/60 Hz

Technical Information

All product dimensions are nominal.

Installation: Drop-in

Drain location: Center rear

Basin area, bottom: 42" x 27" (1067 mm x 686 mm)

Basin area, top: 54" x 30" (1372 mm x 762 mm)

Weight: 91 lbs (41.3 kg)

Minimum floor load: 41 lbs/ft² (200.2 kg/m²)

Water depth: 16" (406 mm)

Water capacity: 81 gal (306.6 L)

Cutout: Drop-in, 64-1/2" x 40-1/2" (1638 mm x 1029 mm)

Electrical component rating: Amplifier: 120 V, 50/60 Hz, 15 W

Minimum flat for door: 4-1/4" (108 mm)

Notes

Measure your actual product for rough-in details.

Install this product according to the installation instructions.

The hot water supply should be 70% of the capacity of the bath or greater. Installations will vary.

Provide one grounded electrical outlet within 24" (610 mm) of each component.

If installing a rim-mount faucet, make sure there is no interference with drain overflow before drilling any holes. Consult local and national codes for minimum air gap requirements if installing a spout on the faucet deck.

Control amplifier fits 16" (406 mm) center studs. 25' (7.6 m) cables are included.